

OILFIELD EQUIPMENTS INC.



Distribution Locations

11269, Windfern Road,
Suite A, Houston,
Texas, 77064 U.S.A.
Cell: +1 713460 5900

8712, West County Road 130,
Unit A, Midland Texas 79706,
U.S.A.
Phone: +1 4324003190

Email: sales@oilfieldcomponents.us | Website: www.oilfieldcomponents.us



ABOUT US

We take pride in introducing our below companies

- OILFIELD EQUIPMENTS INC. Houston, Texas
- OILFIELD EQUIPMENTS INC. Midland, Texas
- OILFIELD EQUIPMENTS PRIVATE LIMITED, Vadodara, Gujarat, India.
- OILFIELD COMPONENTS (INDIA) PRIVATE LIMITED, Rajkot, Gujarat, India
- OILFIELD EQUIPMENTS PRIVATE LIMITED, Morbi, Gujarat, India.
- OILFIELD EQUIPMENTS PRIVATE LIMITED, Rajkot, Gujarat, India.

Since our inception in 2009, our commitment to business ethics has been a huge part in expanding as a business. We are manufacturers and distributors of oilfield equipment and components.

Companies based in India focus on the manufacturing aspects whereas companies in the USA focus on sales and distribution. These high-quality (Made in India) products are shipped directly to our customers and distributors while providing timely delivery.

We have a sales team that aims to address customer requirements and queries which is then communicated to our manufacturers in India to achieve an accurate and best quality product.

These manufacturing units are equipped with forging machines, heat treatment processes as well as machining and testing processes. We are proud announce our regulatory compliance with American Petroleum Institute (API) 20C, API 6A as well as API SPEC Q1.



PRODUCT INDEX

	Page No.
Hammer Unions	1
Hose Union Fittings	2
Integral Union Connections	3
Swivel Joints	4
Swivel Joint / Short Radius	5
C&C Hoses	6
Steel Hoses (Pup Joint)	6
API 6A Ring Gaskets	7
API 6A Flanges	8
Adapter Flanges	8
Plug Valves	9
Positive Choke	10
Adjustable Choke	11
Choke Seat & Stem	15
Choke Beans	16



Hammer Unions

OFE Hammer Unions are available in a wide range of sizes and in working pressures of upto 15,000 psi. Pressure seal, non-pressure seal, and welded styles are offered in various sizes. These Hammer Unions provide pressure-tight, positive sealing and are available for standard services and sour gas models. OFE Hammer Unions for sour gas services are specially heat-treated for controlled hardness and uses fluorocarbon elastomer seal rings.

Specifications For Threaded And Butt Weld Hammer Unions

Fig. No.	Assembly Color Code for Standard Service	Pressure Rating (PSI)				Nominal Pipe Sizes															
		Standard Service		Sour Gas Service		(in.)	1/2	1	1-1/4	1-1/2	2	2-1/2	3	4	5	6	8	10	12		
		Cold Working	Test	Cold Working	Test	(mm)	13	25	32	38	50	65	80	100	125	150	200	250	300		
50		500	750	N/A	N/A																
100		1,000	1,500	N/A	N/A																
101		1,000	1,500	N/A	N/A																
200		2,000	3,000	2,000	3,000																
201		2,000	3,000	2,000	3,000																
206		2,000	3,000	2,000	3,000																
207		2,000	3,000	2,000	3,000																
211		2,000	3,000	N/A	N/A																
300		2,000	3,000	N/A	N/A																
400		4,000	6,000	4,000	6,000																
602		6,000	9,000	6,000	9,000																
1002		10,000	15,000	7,500	11,250																
1003		10,000	15,000	7,500	11,250																
1004		10,000	15,000	7,500	11,250																
1502		15,000	22,500	10,000	15,000																
2002		20,000	30,000	N/A	N/A																
2202		N/A	N/A	15,000	22,500																
6666		6,000	9,000	N/A	N/A																

* Indicates different Cold Working Pressure due to other design factor - Difference as shown below:

- 5", 6", 12" : Figure 400, Cold Working Pressure 2,500 PSI & Test Pressure 4,000 PSI
- 5", 6" : Figure 1002, Butt Weld, Cold Working Pressure 7,500 PSI & Test Pressure 11,250 PSI Std. Service
- 4", 5" : Figure 1003, Butt Weld, Cold Working Pressure 7,500 PSI & Test Pressure 11,250 PSI Std. Service
- 5", 6" : Figure 1002, Butt Weld, Cold Working Pressure 5,000 PSI & Test Pressure 7,500 PSI Sour Service
- 4", 5" : Figure 1003, Butt Weld, Cold Working Pressure 5,000 PSI & Test Pressure 7,500 PSI Sour Service
- 1/2" : Figure 300, Butt Weld, Cold Working Pressure 15,000 PSI & Test Pressure 20,000 PSI Zinc Plated

Hammer Unions



**Fig. 100
Black Nut Yellow Subs**
An economical union with precision machined metal-to-metal sealing surfaces for air, water, oil or gas service to 1,000 psi NSCWP*.



**Fig. 200
Blue Nut Gray Subs**
A precision metal-to-metal sealing surface between male and female subs for air, water, oil, gas and mud service to 2,000 psi NSCWP*.



**Fig. 206
Blue Nut Gray Subs**
A precision metal-to-metal seal plus O-ring seal for air, water, oil, gas and mud service to 2,000 psi NSCWP*.



**Fig. 207
Blue Cap Gray Subs**
Interchangeable Fig. 206 sub with blanking cap and O-ring seal to assure no-leak closure of manifolds and lines to 2,000 psi NSCWP*.



**Fig. 400
Black Nut Red Subs**
Features a precision ball and cone sealing surface for sure metal-to metal seal for air, water, oil, gas and mud service to 4,000 psi NSCWP*.



**Fig. 402
Black Nut Black Subs**
A resilient lip-type seal for air, water, oil or mud service to 4,000 psi NSCWP*.



**Fig. 602
Black Nut Orange Subs**
A replaceable lip-type seal ring minimizes fluid flow turbulence and gives pressure seal for air. Water, oil, gas and mud service to 6,000 psi NSCWP*.



**Fig. 1002
Red Nut Blue Subs**
A resilient lip-type seal protects ball and cone seal against abrasion in air, water, oil, gas and mud service to 10,000 psi NSCWP*.

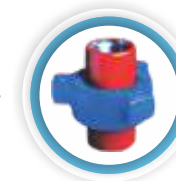

**Fig. 1502
Blue Nut Red Subs**
For manifold and truck mountings or installations encountering high pressures including air, water, oil, gas and mud services to 15,000 psi NSCWP*.



**Fig. 2002
White Nut White Subs**
For cementing, fracturing, acidizing, testing and choke-and-kill lines where extreme pressures are encountered to 20,000 psi NSCWP*.



**Fig. 2202
Green Nut Green Subs**
Especially for sour gas service; with heat-treated components, fluoroelastomer seal rings. For service to 15,000 psi NSCWP*.

Hose Union Fittings



OFE Figure 206 Hose Fitting is made of high quality forged ductile iron. This union is also referred to as a Hose Barb Union. It features a union end connection that is interchangeable with a Figure 200/206 connection, and it comes with an integral hose shank on both the male and female sub. The Figure 206 union is designed to save time and money by eliminating the need to weld a hose nipple onto a Figure 200/206 hammer union. This union is uniquely designed to be tested to twice the rated working pressure, which is often a requirement for hoses used in oilfield applications.

Standard Service		H2S Service**	
NSCWP	Test	NSCWP	TEST
400 PSI	800 PSI	400 PSI	800 PSI

*All Working Pressures are Non-shock Cold Working Pressure Ratings (NSCWP)



Integral Union Connections

OFE manufactures a quality line of high-pressure Integral Union Connections in a broad range of configurations and sizes ranging from 2" and 3" and in pressure ratings up to 15,000 psi NSCWP*. Manufactured from high strength alloy steel, OFE integrals feature a lightweight design which distinguishes us. All our Integral Union Connections are subjected to controlled heat-treat process.

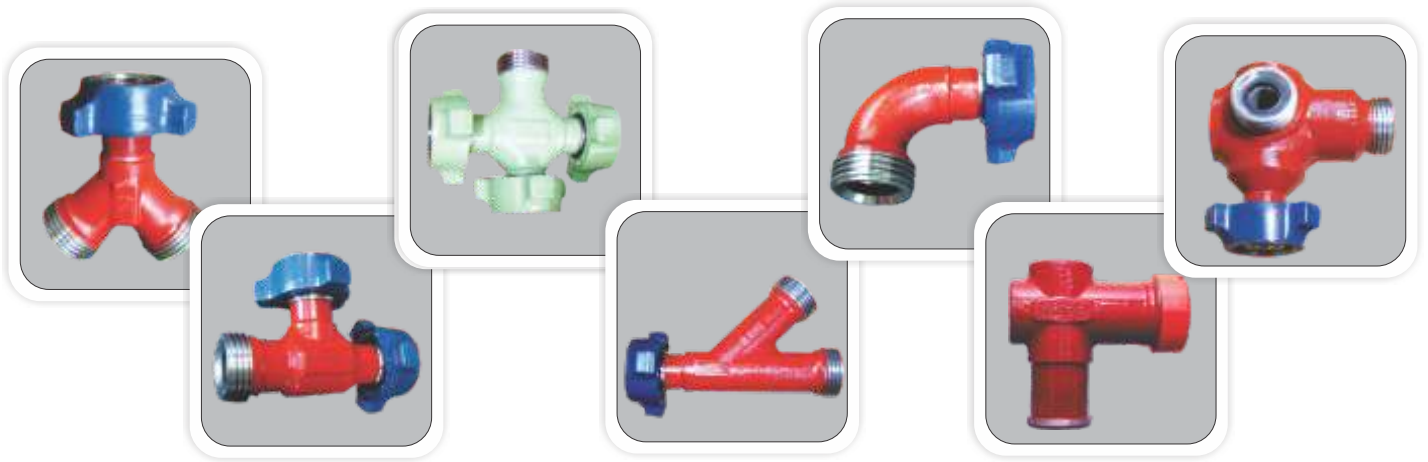

Size	Fig. 602 6,000 psi*	Fig. 1002 10,000 psi*	Fig. 1502 15,000 psi*	Fig. 1502 10,000 psi* H2S	Fig. 2002 15,000 psi*	All Female (Thread)	All Male (Wing)	Combination styles and Sizes
2"			•	•	•	•	•	•
3"	•		•	•	•	•	•	•

*Non-Shock Cold Working Pressure

Union Changeover and Crossover Adaptors



Available in a variety of sizes and thread types in female-to-male, female-to-female, and male-to-male configurations from 1" thru 4", in pressure rating from 6,000 to 15,000 psi NSCWP* in standard service, and up to 10,000 psi in sour gas service.

Union Bull, Gauge and Lifting Bull Plugs



Available in a variety of sizes and thread types in female-to-male, female-to-female, and male-to-male configurations from 1" thru 4", in pressure rating from 6,000 to 15,000 psi NSCWP* in standard service, and up to 10,000 psi in sour gas service.

Union Male and Female to Pipe and Tubing Thread Swages



Available in numerous sizes and threaded configurations from 1" thru 4" in pressure rating from 6,000 to 10,000 psi NSCWP*.

Swivel Joints

OFE 2" FIG1502 and 3" Fig 1502 Long Radius Swivel Joints are redesigned to make them superior and longer lasting. It's new features have extended the products life while maintaining uniform flow.

New features include:

- Additional erosion material under critical ball race locations.
- More stable assembly with better load distribution in 3" Fig. 1502 series, featuring longer ball race life.
- Better distribution of material for more robust female ball care components in 2" Fig. 1502 and 3" Fig. 1502 models.
- No danger for any mismatches.
- Available in traditional hammer union styles.



All OFC swivel joints feature uniform wall thickness throughout for longer and more uniform flow of fluids (including slurries and abrasives), elastomeric packing for service to instream packing that is designed not to enter stream regardless of velocity and improved lubrication.

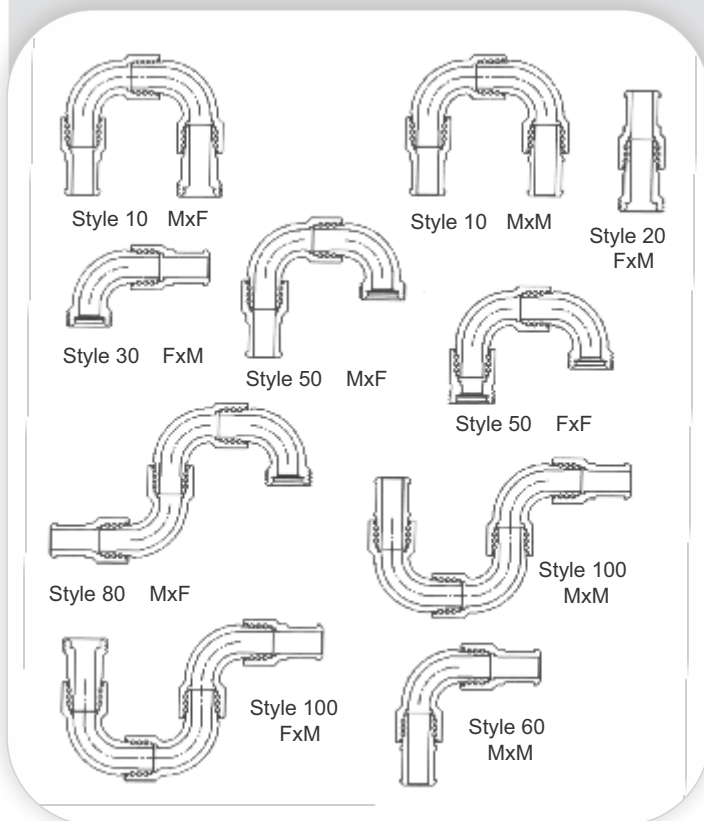

Pressure Rating	Size			
	2"	2" H2S	3	3" H2S
Style 10 Fig. 1502 MxF	●	●	●	●
Style 10 Fig. 1502 MxM	●	●	●	●
Style 20 Fig. 1502 MxF	●	●	●	●
Style 30 Fig. 1502 MxF	●	●	●	●
Style 50 Fig. 1502 MxF	●	●	●	●
Style 60 Fig. 1502 MxF	●	●	●	●
Style 80 Fig. 1502 MxF	●		●	●
Style 50 Fig. 602 MxF				
Style 100 Fig. 1502 MxF	●	●	●	
Style 100 Fig. 1502 MxM	●	●	●	



Swivel Joint / Short Radius



- Size : 2"
- End Type : Customized
- Test Pressure : 9,000 PSI
- CWP : 6,000 PSI (413.68 bar)
- Service : Standard, H₂S
- Uses: Cementing, Drill Mud, Fracturing Fluids, Well Servicing
- MTR and Test Reports are provided as per request

Swivel Joint Short Radius Repair Kit

No.	Item	Qty.
1	O-ring	1
2	Pressure Seal	1
3	Ball	52
4	Nipple Nut O-Ring	1
5	Nipple Nut	1
6	Grease Fitting	1



Style 10



Style 20



Style 30



Style 40



Style 50



Style 60



Style 70



Style 80

C&C Hoses

Steel Hose Loops

OFE Steel Hose Loops are used for a variety of high pressure well service applications including discharge lines, water lines, cementing and circulating lines, well test lines and temporary flow lines.

Our Steel Hoses utilize field proven OFE swivel joints for greater flexibility, shock and vibration resistance, and more uniform flow.

OFE wing union end connections are use for fast, pressure tight makeup and breakout.

These rugged hoses handle a full range of fluids with cold working pressure up to 15,000 PSI and come in sizes and configurations to meet your needs.

Hoses for sour gas service are available at cold working pressure up to 10,000 psi. OFE hoses are designed to easily and conveniently fold up for storage and transportation.



OFC Model	Color Code	Method of Construction			NSCWP* (PSI)	Size (In.)	
		Threaded	NPS	Integral		2	3
Long Radius Swivel Joints	Olive Green [†]		•	•	10,000	•	•
	Red		•	•	15,000	•	•
Long Radius Swivel Joints	Black	•			10,000	•	

[†] Sour Gas Service

*Non-Shock Cold Working Pressure

Steel Hoses (Pup Joint)



OFE Integral Pup Joints with wing union end connections for an uninterrupted and greater flow.

This light weight piping is available in lengths up to 10 feet to handle fluids at cold working pressure of 15,000 PSI. They are used in high-pressure discharge lines, auxiliary flow lines, choke-and-kill lines and for abrasive applications.

OFE also manufactures flow line piping in non-pressure seal thread ranging from 6,000 to 15,000 PSI, for up to 20 feet in length.

Integral Style

Size (In.)	Type of Service	NSCWP* (PSI)	End Connection
2	Standard	15,000	Fig. 1502 Union
2	Sour Gas	10,000	Fig. 1502 Union
3	Standard	15,000	Fig. 1502 Union
3	Sour Gas	10,000	Fig. 1502 Union

NPS & Butt Weld Piping

Style	NSCWP* (PSI)	1"	1½"	2"	3"	Non Press Seal	Butt Weld
Fig. 602	6,000	•	•		•	•	•
Fig. 1002	10,000	•	•	•		•	•
Fig. 1502 [†]	10,000	•	•	•	•		•
Fig. 1502	15,000	•	•	•	•	•	•

*Non-Shock Cold Working Pressure

[†]Sour Gas Service



API 6A Ring Gaskets

Precision Finish

- Material Stainless Steel, Low carbon or Inconel.
- Dual Certification for low carbon
- Full traceability



API 6A Spec Flange Bolt & Ring Chart

API Pressure Rating	Flange Size & Bore	Ring Gasket		Number of Studs	Stud Dimensions	
					Diameter	Length
2000 lb	2 1/16"	R-23	RX-23	8	5/8"	4 3/4"
	2 9/16"	R-26	RX-26	8	3/4"	5 1/4"
	3 1/8"	R-31	RX-31	8	3/4"	5 1/2"
	4 1/16"	R-37	RX-37	8	7/8"	6 1/4"
	5 1/8"	R-41	RX-41	8	1"	7 1/4"
	7 1/16"	R-45	RX-45	12	1"	7 1/2"
	9"	R-49	RX-49	12	1 1/8"	8 1/2"
	11"	R-53	RX-53	16	1 1/4"	9 1/4"
	13 5/8"	R-57	RX-57	20	1 1/4"	9 1/2"
	16 3/4"	R-65	RX-65	20	1 1/2"	10 3/4"
21 1/4"	R-73	RX-73	24	1 5/8"	12 1/2"	
6BX	26 3/4"	BX-167		20	1 3/4"	14 1/4"

API Pressure Rating	Flange Size & Bore	Ring Gasket		Number of Studs	Stud Dimensions	
					Diameter	Length
3000 lb	2 1/16"	R-24	RX-24	8	7/8"	6"
	2 9/16"	R-27	RX-27	8	1"	7"
	3 1/8"	R-31	RX-31	8	7/8"	6 1/4"
	4 1/16"	R-37	RX-37	8	1 1/8"	7 1/2"
	5 1/8"	R-41	RX-41	8	1 1/4"	8 1/4"
	7 1/16"	R-45	RX-45	12	1 1/8"	8 1/2"
	9"	R-49	RX-49	12	1 3/8"	9 1/2"
	11"	R-53	RX-53	16	1 3/8"	10"
	13 5/8"	R-57	RX-57	20	1 3/8"	10 3/4"
	16 3/4"	R-66	RX-66	20	1 5/8"	12 1/4"
20 3/4"	R-74	RX-74	20	2"	15"	
6BX	26 3/4"	BX-168		24	2"	17 1/2"

API Pressure Rating	Flange Size & Bore	Ring Gasket		Number of Studs	Stud Dimensions	
					Diameter	Length
5000 lb	2 1/16"	R-24	RX-24	8	7/8"	6 1/4"
	2 9/16"	R-27	RX-27	8	1"	7"
	3 1/8"	R-35	RX-35	8	1 1/8"	7 3/4"
	4 1/16"	R-39	RX-39	8	1 1/4"	8 1/2"
	5 1/8"	R-44	RX-44	8	1 1/2"	10 3/4"
	7 1/16"	R-46	RX-46	12	1 3/8"	11 1/4"
	9"	R-50	RX-50	12	1 5/8"	12 1/2"
	11"	R-54	RX-54	12	1 7/8"	14 1/2"
	13 5/8"	BX-160		16	1 5/8"	12 3/4"
	16 3/4"	BX-162		16	1 7/8"	14 3/4"
18 3/4"	BX-163		20	2"	17 1/2"	
6BX	21 1/4"	BX-165		24	2"	18 3/4"

API Pressure Rating	Flange Size & Bore	Ring Gasket		Number of Studs	Stud Dimensions	
					Diameter	Length
10000 lb	1 13/16"	BX-151		8	3/4"	5 1/4"
	2 1/16"	BX-152		8	3/4"	5 1/2"
	2 9/16"	BX-153		8	7/8"	6 1/4"
	3 1/16"	BX-154		8	1"	7 1/4"
	4 1/16"	BX-155		8	1 1/8"	8 1/4"
	5 1/8"	BX-169		12	1 1/8"	9"
	7 1/16"	BX-156		12	1 1/2"	11 3/4"
	9"	BX-157		16	1 1/2"	13 1/4"
	11"	BX-158		16	1 3/4"	15 1/2"
	13 5/8"	BX-159		20	1 7/8"	17 3/4"
16 3/4"	BX-162		24	1 7/8"	17 3/4"	
18 3/4"	BX-164		24	2 1/4"	22 1/2"	
6BX	21 1/4"	BX-166		24	2 1/2"	24 1/2"

API Pressure Rating	Flange Size & Bore	Ring Gasket		Number of Studs	Stud Dimensions	
					Diameter	Length
15000 lb	1 13/16"	BX-151		8	7/8"	5 3/4"
	2 1/16"	BX-152		8	7/8"	6 1/4"
	2 9/16"	BX-153		8	1"	7"
	3 1/16"	BX-154		8	1 1/8"	8"
	4 1/16"	BX-155		8	1 3/8"	9 1/2"
	5 1/8"	BX-169		12	1 1/2"	11 1/2"
	7 1/16"	BX-156		16	1 1/2"	13"
	9"	BX-157		16	1 7/8"	15 3/4"
	11"	BX-158		20	2"	19 1/2"
	13 5/8"	BX-159		20	2 1/4"	21"
6BX	18 3/4"	BX-164		20	3"	26 3/4"

API Pressure Rating	Flange Size & Bore	Ring Gasket		Number of Studs	Stud Dimensions	
					Diameter	Length
20000 lb	1 13/16"	BX-151		8	1"	7 3/4"
	2 1/16"	BX-152		8	1 1/8"	8 1/2"
	2 9/16"	BX-153		8	1 1/4"	9 1/2"
	3 1/16"	BX-154		8	1 3/8"	10 1/4"
	4 1/16"	BX-155		8	1 3/4"	12 1/4"
	7 1/16"	BX-156		16	2"	17 3/4"
	9"	BX-157		16	2 1/2"	21 3/4"
	11"	BX-158		16	2 3/4"	23 3/4"
	13 5/8"	BX-159		20	3"	30"
	6BX	13 5/8"	BX-159		20	3"

API 6A Flanges

OFE is a manufacturer of various types of Flanges and Pipe Fittings required by the oilfield, petrochemical and different process industries. Our name is synonymous with high quality manufacturing, precision machining and unparalleled dedication to quality excellence which has kept us in the fore front of the oil industry.



Weld Neck Flange



Threaded Flange



Blind Flange



Test Blind Flange

Adapters Flanges

OFE Wellhead Flange Adapters are designed to be used in the upper most position on wellheads and therefore enables wireline and other well service operations to be performed through the wellhead into the well bore.

OFE Wellhead Flange Adapters are available in various bore sizes and with quick union connections compatible with Bowen and Otis type quick unions. Additionally, Flange / Adapters are supplied for standard or H₂S service and working pressure up to 15,000 psi.





Plug Valves

- Standard service is used up to 15,000 PSI and tested at 22,500 PSI
- H₂S service is used up to 10,000PSI and tested at 15,000PSI
- Rugged Construction with Forged Alloy Steel Body
- Reliable Performance at high working pressure
- Bottom Entry design, Top Entry design, Easy Maintenance
- Valve Parts are Interchangeable with most major designs
- Suitable for variety of high pressure applications such as fracturing, cementing, acidizing and etc.
- Each valve is serialized
- MTR and Test Report are available upon request



Plug Valve

No.	Item	Qty.
Ass'y	Plug Valve 1502 Handle Type	1
1	Cap Screw	2
2	Washer 1 (Small)	2
3	Washer 2 (Bigger)	2
4	Handle Adapter	1
5	Stop Bolt	1
6	Stop Collar	1
7	Grease Fitting	1
8	Body	1
9	Wing Nut	1
10	Segment	3
11	Retainer Ring	1
12	Lip Seal	1
13	Plug Seal	2
14	Plug	1
15	Roll Pin	2
16	Insert	2
17	Insert O-ring	2
18	Adjusting Nut O-ring	1
19	Adjusting Nut	1



Plug Valve Repair Kit

No.	Item	Qty.
1	Plug Seal	2
2	Plug	1
3	Metal Seat	1
4	Metal Seat O-Ring	2
5	Adjusting Nut O-Ring	1

Size	End Connection	Service	Working Pressure	Test Pressure	Operation type	Dimensions (Inch)				
						A	B	C	D	E
2x1	1502 MxF	Standard	15,000	22,500	Handle	10.53	4.74	4.50	4.50	1.00
		H ₂ S	10,000	15,000						
2x2	LP Thread	Standard	10,000	15,000	Handle	8.50	5.41	5.25	6.85	2.05
	1502 MxF	Standard	15,000	22,500						
		H ₂ S	10,000	15,000						
	3x3	1502 MxF	Standard	15,000						
H ₂ S			10,000	15,000	10.95					

* Each size can be changed as customer's requirements.

Choke



2" 1502 Positive Choke

- 2" Fig 1502 MxF with 3/4" or 1" Orifice and 3" Fig 1502 MxF with 2" Orifice.
- Standard service is used up to 15,000 PSI and tested at 22,500 PSI
- H₂S service is used up to 10,000PSI and tested at 15,000PSI
- Hammer Union End Connection
- Forged alloy steel body, stainless steel and tungsten carbide parts
- Parts are interchangeable with major brands
- Suitable for a broad range of applications including wellheads, well testing, stream injection, choke and kill manifolds and well clean operations, etc.



2" 1502 Adjustable Choke



3" 1502 Adjustable Choke

2" Positive Choke



2" Positive Choke

No.	Item	Qty.
Assy	Positive Choke 1502	1
13	Wing Nut	3
14	Lip Seal	2
15	Choke Body	1
16	Plug Stem	1
17	Stem Cap	1
18	Retainer Ring	2
19	Segment	6
20	Choke Bean	1
21	Choke Saver	1
22	Blind Male Sub	1

2" Positive Choke Repair Kit

No.	Item	Qty.
20	Choke Bean	1

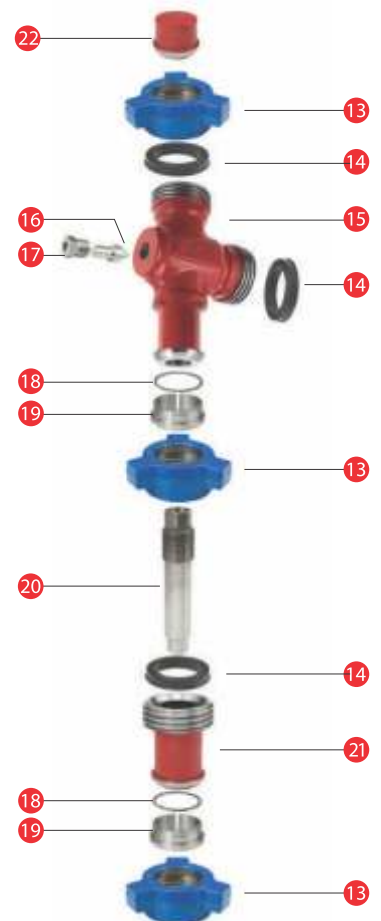



2" Adjustable Choke



2" Adjustable Choke

No.	Item	Qty.
Ass'y	Adjustable Choke 1502	1
1	Stem Nut	1
2	Washer	1
3	Hand Wheel	1
4	Indicator	1
5	Lock Screw	1
6	Chock Stem	112
7	Stem Guide	2
8	Stem Seal	1
9	Junk Ring	1
10	Snap Ring	1
11	Choke Bonnet	1
12	Thumb Screw	1
13	Grease Fitting	1
14	Wing Nut	3
15	Lip Seal	2
16	Chock Body	1
17	Plug Stem	1
18	Stem Cap	1
19	Retainer Ring	2
20	Segment	6
21	Chock Seat	1
22	Coke Saver	1

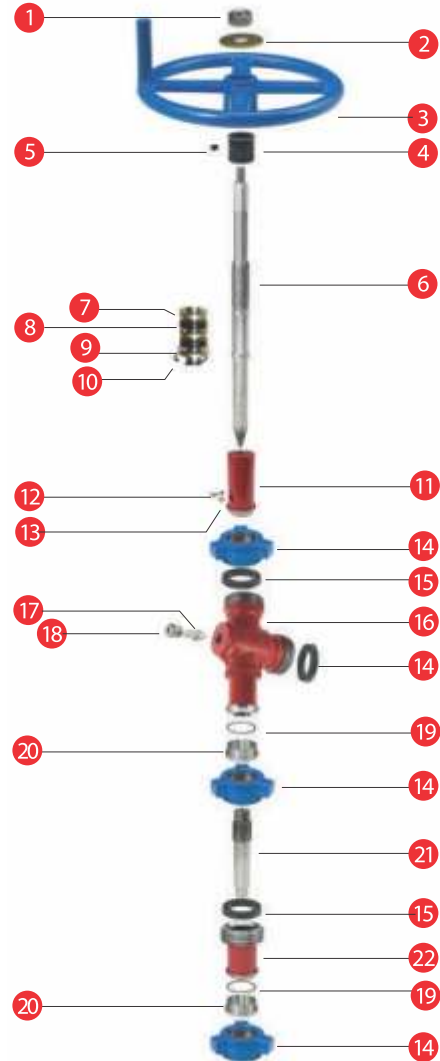

2" Adjustable Choke Repair Kit

No.	Item	Qty.
7	Stem Guide	2
8	Stem Seal	2
9	Junk Ring	1
10	Snap Ring	1

* Each size can be changed as customer's requirements.

3" Adjustable Choke



3" Adjustable Choke

No.	Item	Qty.
Assy	Adjustable Choke 1502	1
1	Stem Nut	1
2	Washer	1
3	Hand Wheel	1
4	Indicator	1
5	Lock Screw	1
6	Chock Stem	1
7	Outsider O-ring	2
8	Seal Piston	1
9	Inside O-Ring	2
10	Stem Seal	1
11	Snap Ring	1
12	Bonnet Bolt	2
13	Thumb Screw	1
14	Bonnet Extension	1
15	Choke Bonnet	1
16	Bonnet O-ring	1
17	Bonnet Back Up Ring	1
18	Wing Nut	2
19	Lip Seal	1
20	Choke Seat	1
21	Choke Body	1
22	Plug Stem	1
23	Stem Cap	1
24	Retainer Ring	1
25	Segment	3
26	Grease Fitting	1

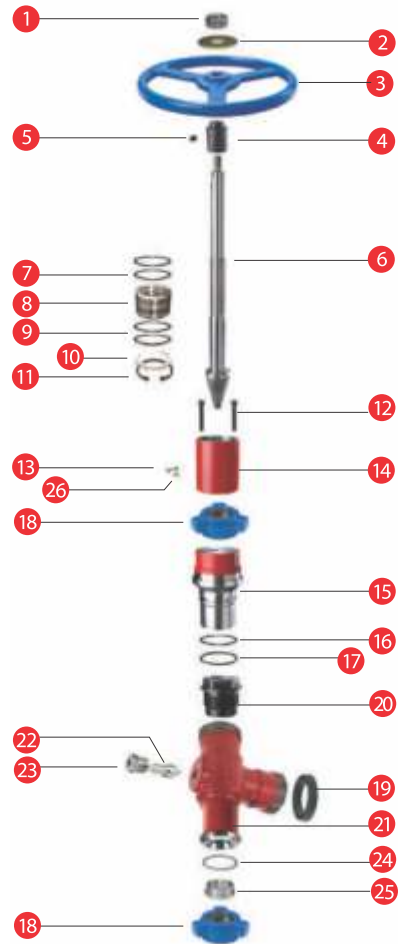

3" Adjustable Choke Repair Kit

No.	Item	Qty.
7	Outside O-ring	2
8	Seal Piston	1
9	Inside O-ring	2
10	Stem Seal	1
11	Snap Ring	1
16	Bonnet O-ring	1
17	Bonnet Back up Ring	1

*Each Size can be changed as customer's requirements.



API 6A Adjustable Choke

Features:

- Long life and low maintenance.
- Body to bonnet contact behind the O-ring seal eliminates bonnet seal extrusion.
- A locking device is set on stem.
- Ideal for many flow regulating services and easily convertible to a positive choke.
- The stem of adjustable choke are made of high strength alloy steel. The materials have the feature of abrasion resistance, erosion resistance and reliable serviceability.
- The valve and seat can be removed by hand, without special tools and without removal of the valve body from the line, by simply removing the bonnet.

Specifications:

	API-6A	ANSI
• Basic Design and Test	2000, 3000, 5000, 10000, 15000, 20000 (Psi)	400, 600, 900, 1500, 2500 (LB)
• Working Pressure	N60, N62, 1-13/16, 2-1/16, 2-9/16, 3-1/16, 3-1/8, 4-1/16	2, 2-1/2, 3, 4, 6, 8
• Main Nominal Size(in)	PSL1, PSL2, PSL3, PSL4	PSL1, PSL2, PSL3, PSL4
• Product Specification Level	PR1, PR2	PR1, PR2
• Performance Requirement Level	AA, BB, CC, DD, EE, FF	AA, BB, CC, DD, EE, FF
• Material Class	Flanged, Thread, Flanged and Thread	Flanged, Weld
• End Connection		

Parts List

No.	Name	Material
1	O-RING	VITON-B
2	SEAT	AISI 4135
3	DRAIN FITTING	AISI 4140
4	MALE ADAPTER	ASTM A182 F6a
5	V-PACKING	VITON
6	FEMALE ADAPTER	ASTM A182 F6a
7	WING NUT	AISI 4130
8	STEM	AISI 4135
9	HANDWHEEL	ASTM 47
10	INDICATOR	CARBON STEEL
11	LUBRICATOR	CARBON STEEL
12	BONNET	AISI 4130
13	O-RING	VITON-B
14	BODY	AISI 4130

Other trim and body material are available upon request.

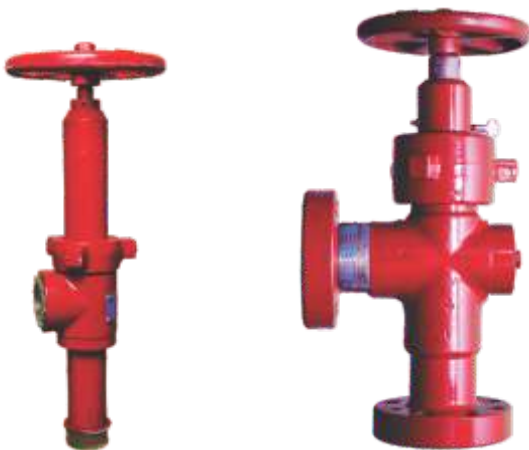
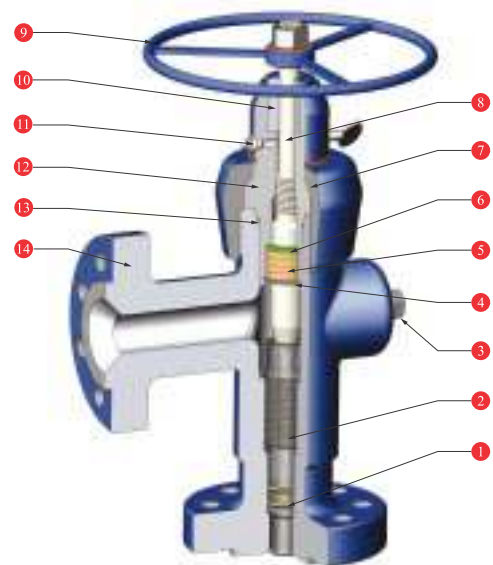

API 6A Positive Choke

Features:

- Body to bonnet contact behind the O-ring seal eliminates bonnet seal extrusion.
- The bean of positive choke are made of ceramic or hard alloy steel. Both have the feature of abrasion resistance, erosion resistance and reliable serviceability.
- Flow bean chamfers are available from 2/64" to 64/64", in 1/64" increments for precise regulation of flow rate.
- The choke bean may be dismantled quickly for change of beans.

Specifications :

- | | |
|---------------------------------|---|
| • Basic Design and Test | API-6A |
| • Working Pressure (Psi) | 2000, 3000, 5000, 10000, 15000, 20000 |
| • Main Nominal Size (in) | 1-13/16, 2-1/16, 2-9/16, 3-1/16, 3-1/8, 4-1/16 |
| • Product Specification Level | PSL1, PSL2, PSL3, PSL4 |
| • Performance Requirement Level | PR1, PR2 |
| • Material Class | AA, BB, CC, DD, EE, FF |
| • End Connection | Flanged, Thread, Flanged and Thread |

Parts List

No.	Name	Material
1	O-RING	VITON-B
2	SEAT	AISI 4135
3	BODY	AISI 4135
4	DRAIN FITTING	AISI 4140
5	WING NUT	AISI 4130
6	O-RING	VITON-B
7	BONNET	AISI 4135
8	GLAND RING	ALLOY STEEL

Other trim and body material are available upon request.

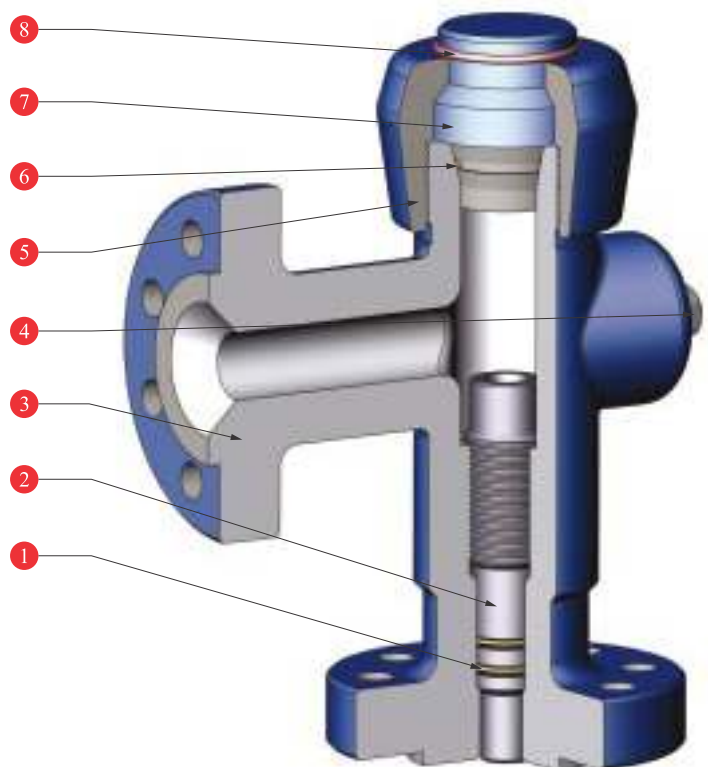



Seat & Stem

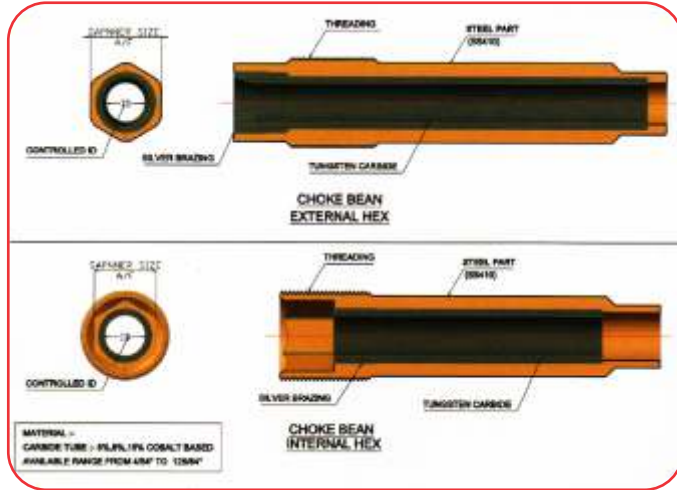

A choke is used to control the flow of fluids and is usually mounted on or close to the christmas tree. High pressure gas/oil, with abrasive sand minerals pass through these chokes at high speed causing a rapid wear. OFE Bean Chokes have steel housings which may be nitrided and are lined with Tungsten Carbide or Zirconia Ceramic inserts, to protect them from corrosive, erosive and abrasive wear.

OFE Bean Chokes are exported all over the world and are known for their international standards. OFE manufactures a wide range of bean chokes to match 'OCT' Type FC140, 'Thronill Craver', 'Gray Tool', 'Cameron' & custom made types. These are mated with a precise diameter seat that forms the choke, through which all the abrasive/ corrosive fluids must pass. Beans are available in complete range of sizes (4/64 to 128/64) generally identified by the choke diameter stated in 64th of an inch. OFE offers Tungsten Carbide / Zirconia lined choke beans & Tungsten Carbide stems for the above makes, other custom designed flanged positive chokes, threaded adjustable chokes & stems/ seats.



H2 Choke Valve Material Recommendations

API MATERIAL CLASS	Body	Bonnet	Choke Trim (Stem, Seat, Bean)
AA & BB General Service	Alloy steel	Alloy steel	Stainless steel or stainless steel and tungsten carbide
CC Non-Sour, High CO ₂	Stainless steel	Stainless steel	Stainless steel or stainless steel and tungsten carbide
DD & EE- 0.5 Sour, Low CO ₂ †	Alloy steel	Alloy steel	Stainless steel and tungsten carbide
FF - 0.5 Sour, High CO ₂ †c	Stainless steel	Stainless steel	Stainless steel and tungsten carbide
HH High H ₂ S, High CO ₂ †	Corrosion resistant alloy	Corrosion resistant alloy	Corrosion resistant alloy and tungsten carbide

*In compliance with NACE Standard MR-01-75

Tungsten Carbide - Seat & Assembly

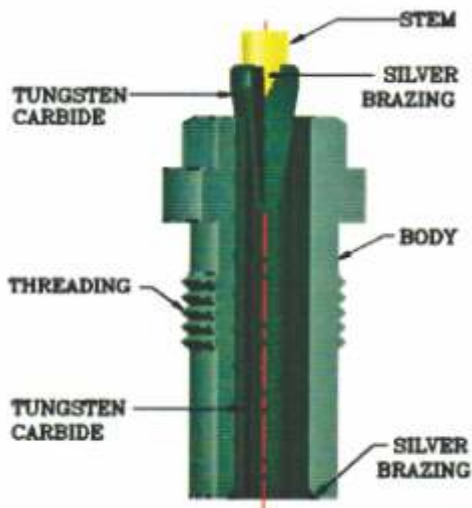

H2 Choke Valve Available Sizes and Pressures

NOMINAL SIZE, IN	Available Needle/Max. Orifice Size, in	Pressure Range, psi
2	1	2,000–10,000
2	1	15,000
3	2	2,000–10,000
4	3	2,000–5,000

Various Types of Choke Bean



Choke Bean Available Sizes

Sr. No.	Type	Orifice Size
1	Internal Hex	4/64" to 48/64"
2	External Hex	49/64" to 64/64"



OUR LOCATIONS

Warehouse & Distributor Centers

Oilfield Equipments Inc.

11269 Windfern Road, Suite A,
Houston Texas 77064, U.S.A.
Phone: +1 713460 5900

Oilfield Equipments Inc.

8712, West County Road 130,
Unit A, Midland Texas 79706, U.S.A.
Phone: +1 4324003190

Email : sales@oilfeldequipments.us | Website : www.oilfeldequipments.us

Manufacturing Units

Oilfield Equipments Private Limited

Plot No.: 417, GIDC Por,
Por - Ramangamdi, Dist- Vadodara,
Gujarat - 391243, India
Cell : +91 9726079096

Oilfield Equipments Private Limited

Plot No : 1, Rajkot Morbi Highway,
Sanala, Nr. Hyundai Showroom,
Morbi, Gujarat - 363641. India
Cell : +91 9726079096

Oilfield Components (India) Private Limited

Plot No. 6 & 7, Dhawani Industrial Park,
National Highway No. 27, Pipaliya Toll Plaza,
Village Ardoi, Dist: Rajkot,
Gujarat - 360030, India
Cell : +91 9726079096

Oilfield Equipments Private Limited

Plot No. 5, Dhawani Industrial Park,
National Highway No. 27, Pipaliya Toll Plaza,
Village Ardoi, Dist: Rajkot,
Gujarat - 360030, India
Cell : +91 9726079096

Email : sales@oilfeldequipments.in | Website: www.oilfieldcomponents.com